

# WOODEN BAR CLAMP

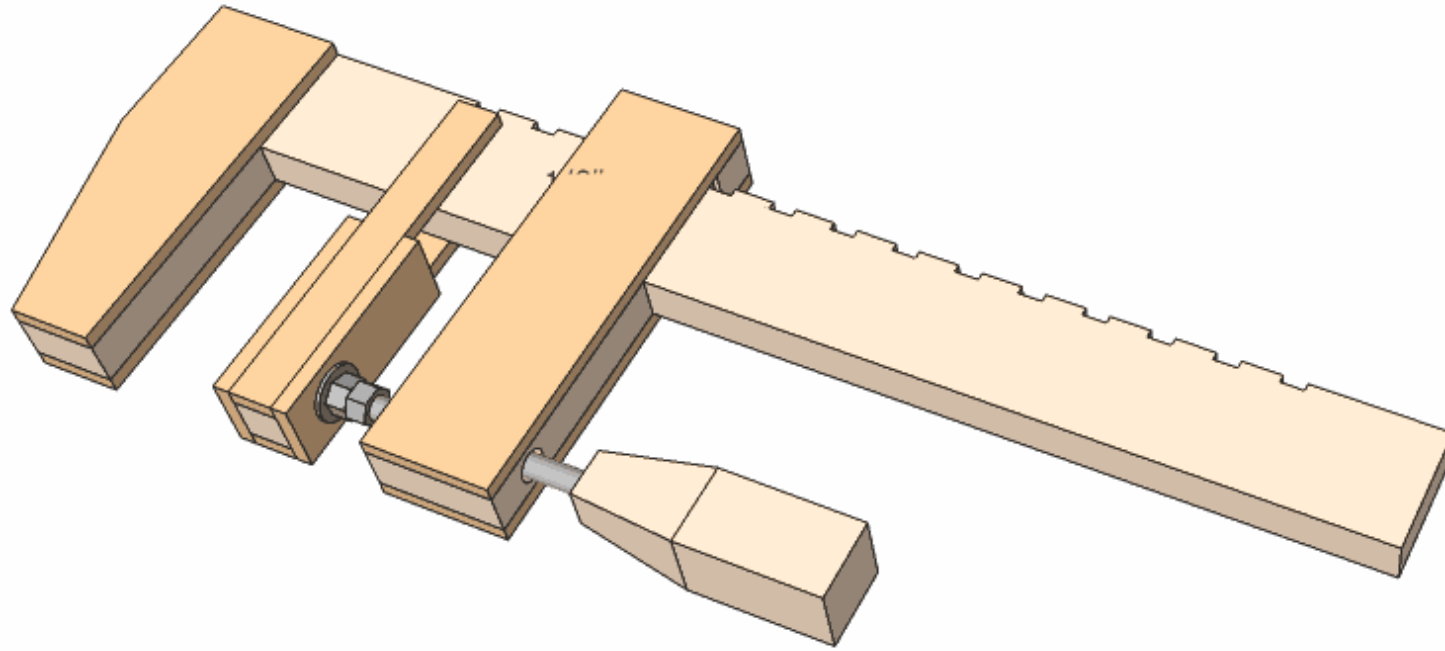

## PARTS 1

PARTS A AND B ARE 3/4" THICK HARDWOOD  
PLANED DOWN TO 23/32"  
PARTS C,D,E AND F ARE FULL 3/4" THICK.

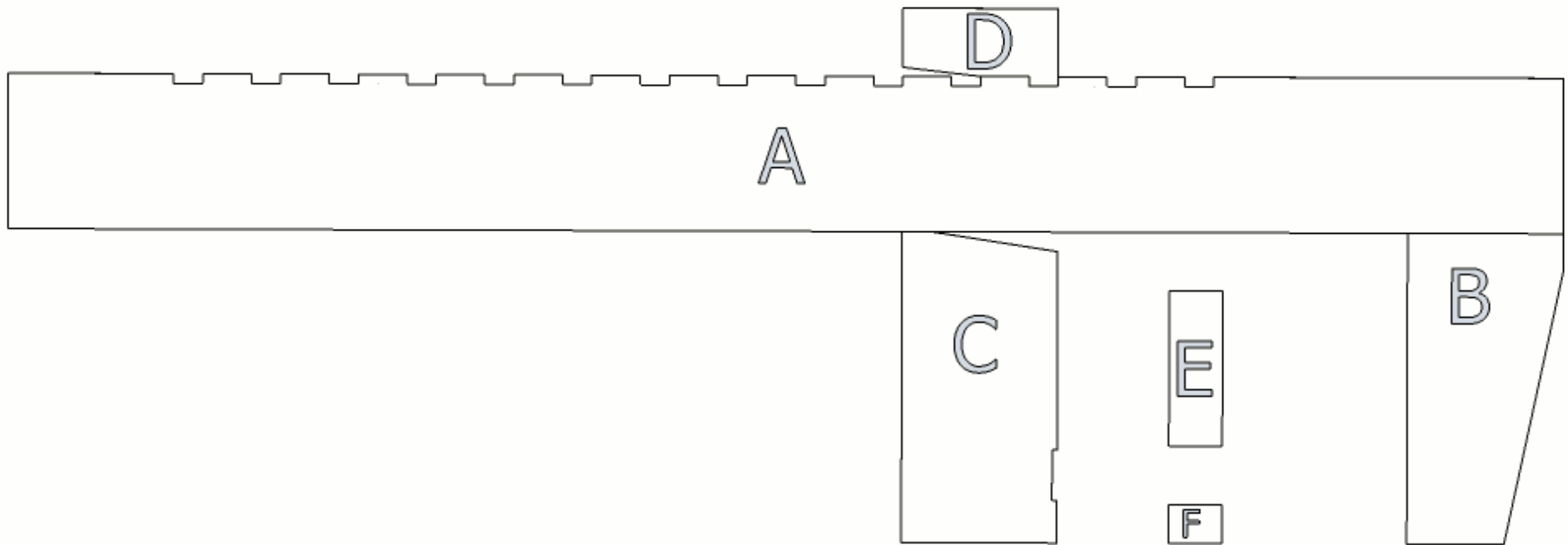

# PARTS 2

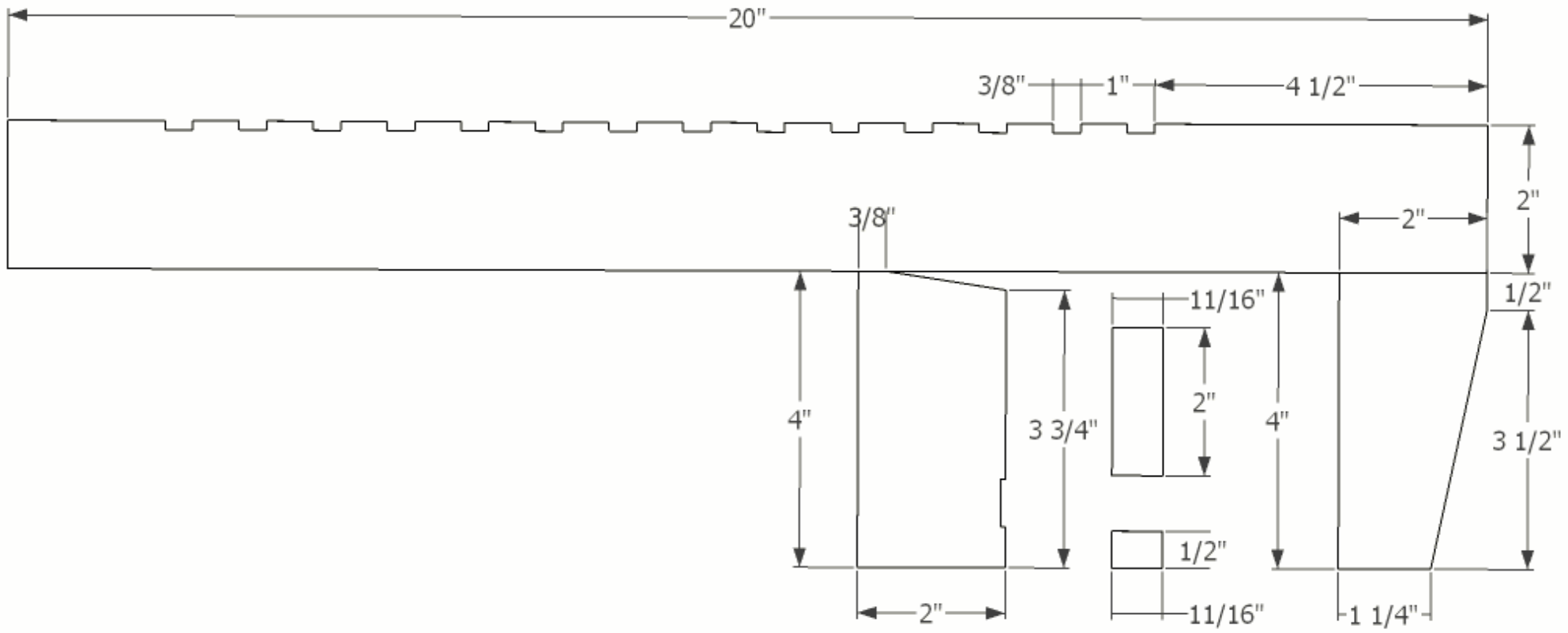

### PARTS 3

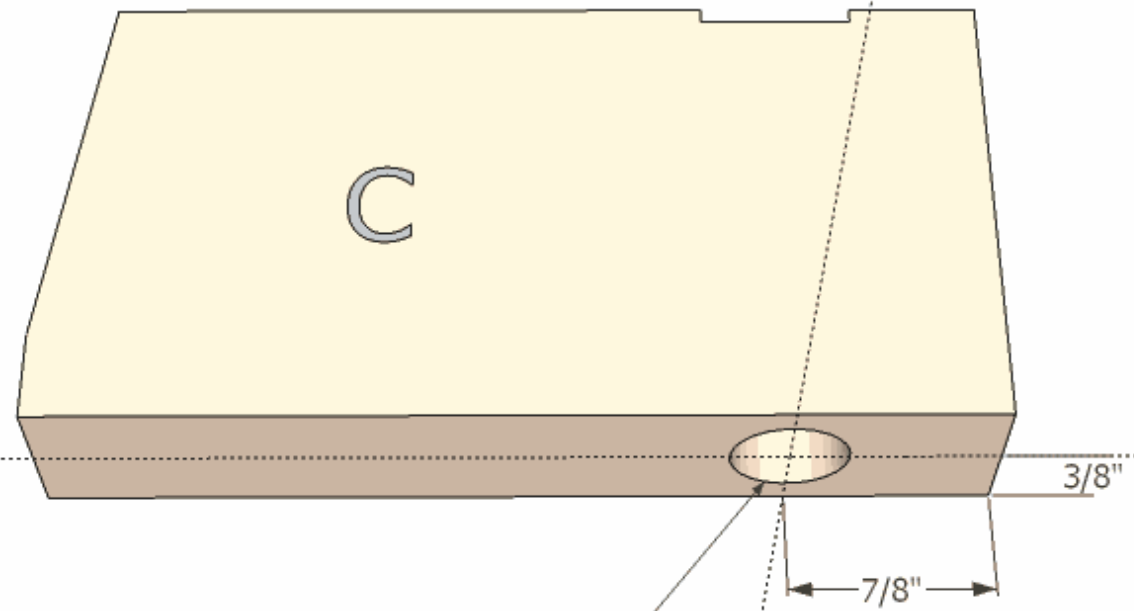
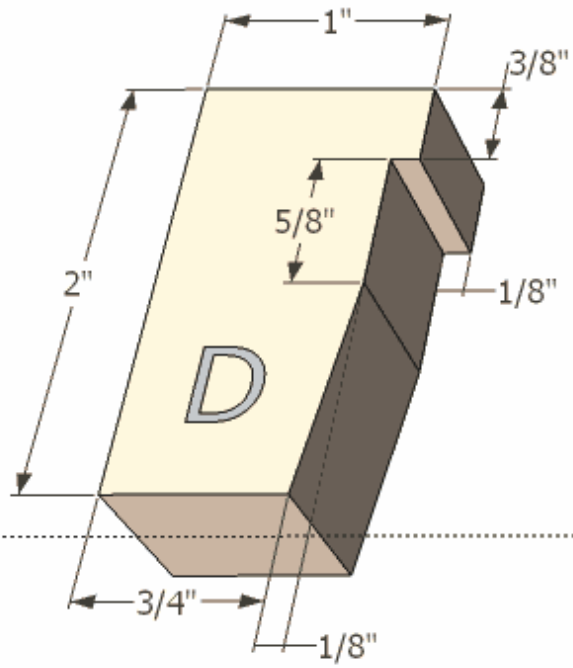

1/2" HOLE THROUGH

## PARTS 4

PARTS G, H, I AND K ARE 1/4" THICK HARDWOOD AND THERE ARE TWO OF EACH.  
PART J IS 1-1/4" THICK HARDWOOD OR SOFTWOOD.

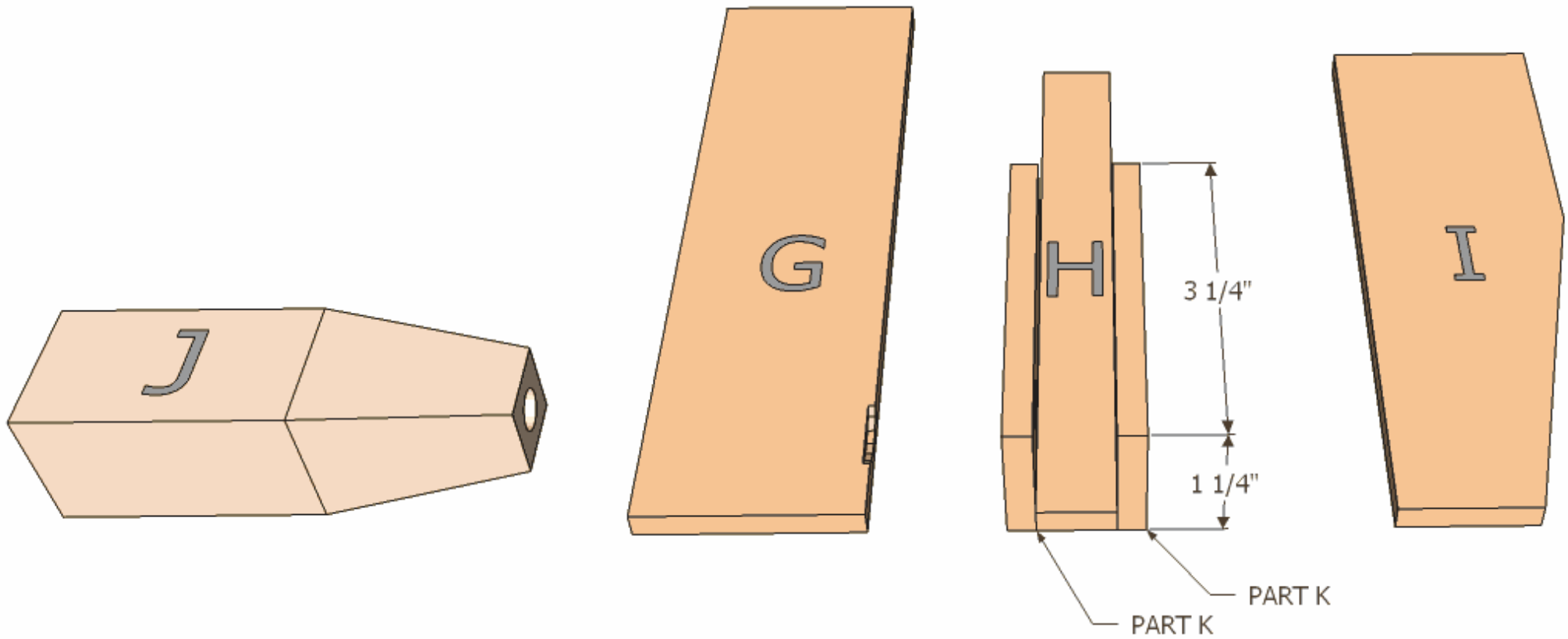

# PARTS 5

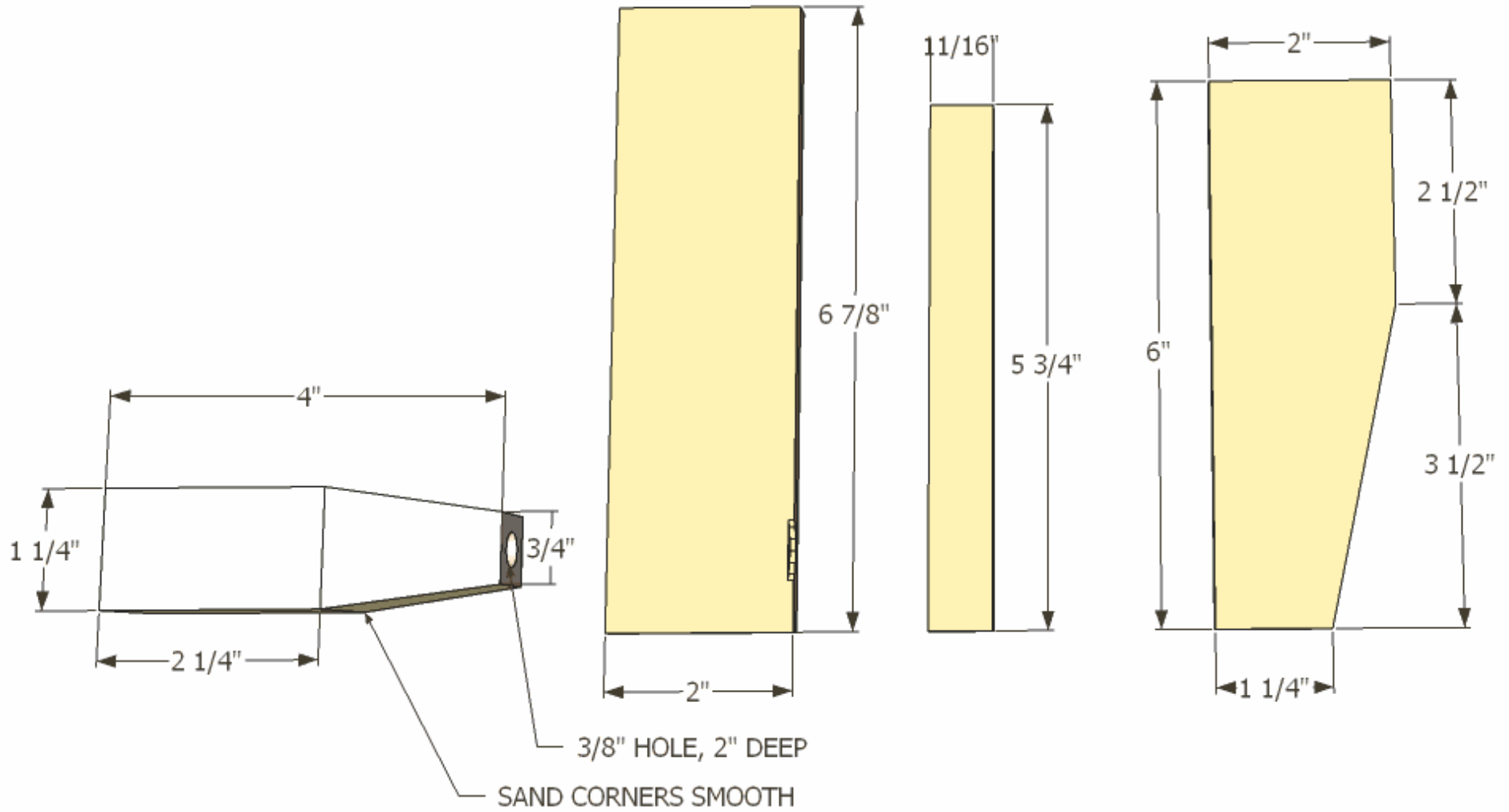

## PARTS 6

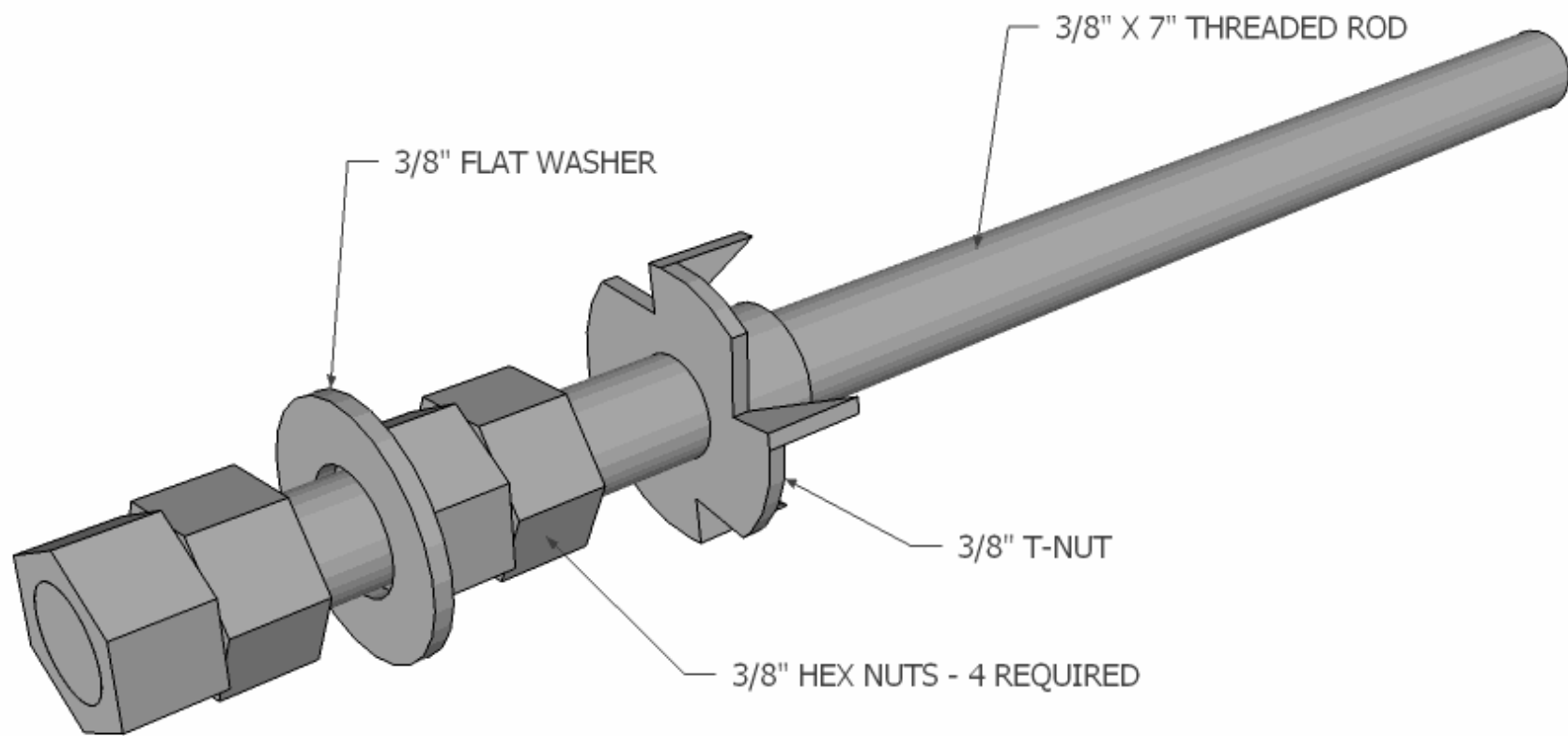

## ASSEMBLY 1

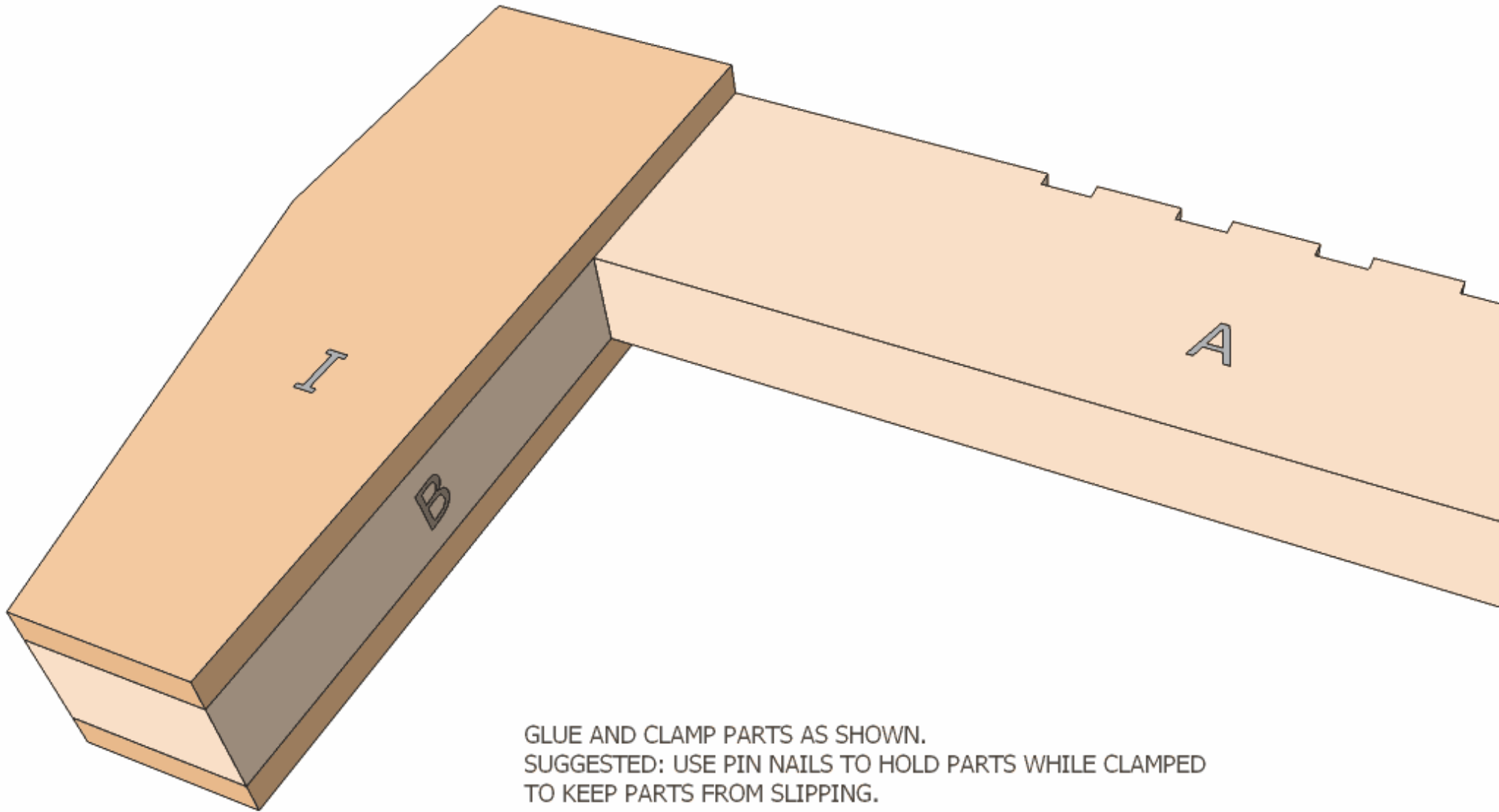

GLUE AND CLAMP PARTS AS SHOWN.  
SUGGESTED: USE PIN NAILS TO HOLD PARTS WHILE CLAMPED  
TO KEEP PARTS FROM SLIPPING.



## ASSEMBLY 2

GLUE AND CLAMP PARTS TOGETHER AS SHOWN.  
ENSURE THAT THE PARTS ARE ORIENTED CORRECTLY  
AND THAT THIS ASSEMBLY FITS PROPERLY ON PART "A"  
BEFORE THE GLUE SETS.

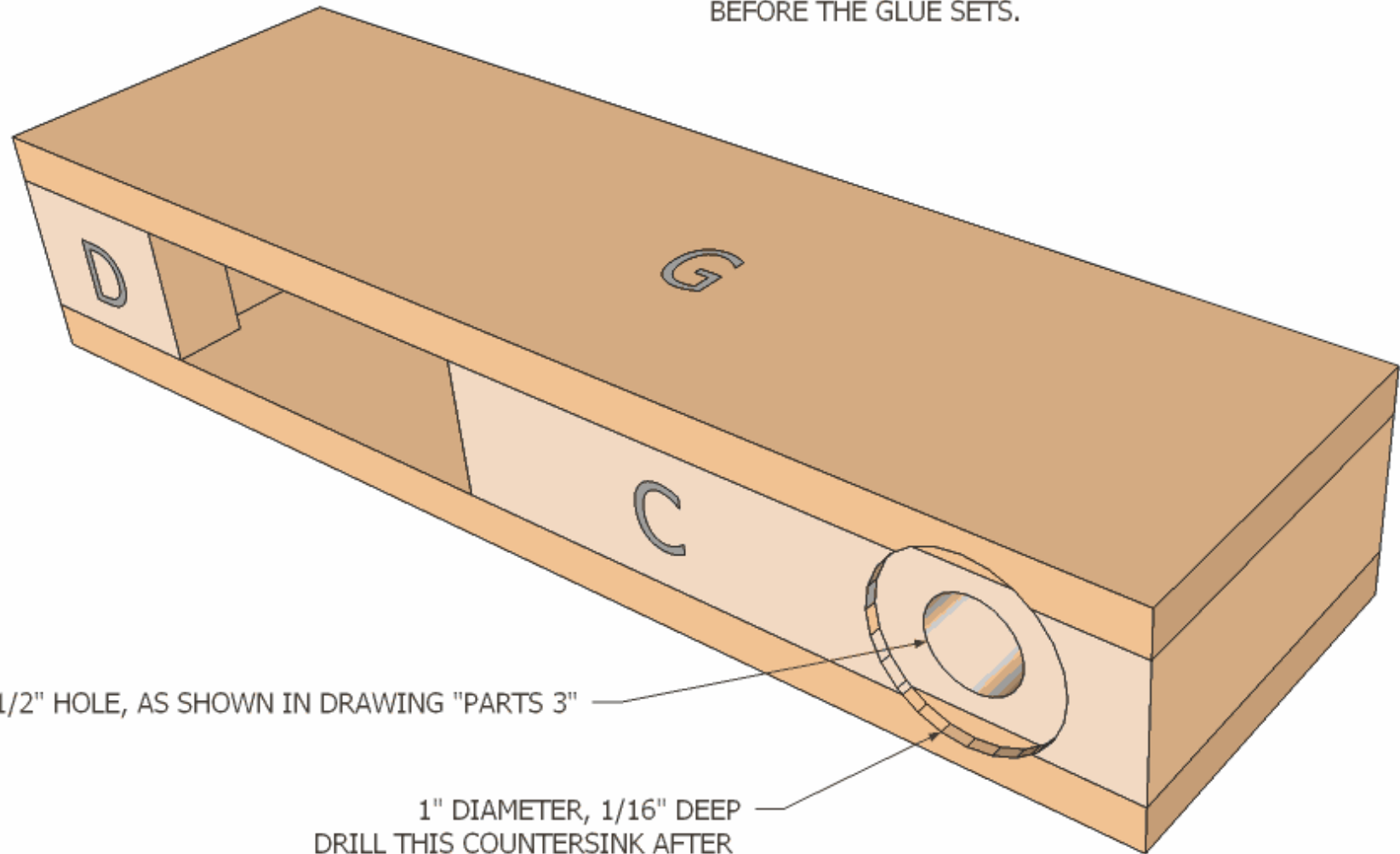

1/2" HOLE, AS SHOWN IN DRAWING "PARTS 3"

1" DIAMETER, 1/16" DEEP  
DRILL THIS COUNTERSINK AFTER  
THE PARTS ARE ASSEMBLED.

## ASSEMBLY 3

GLUE AND CLAMP PARTS AS SHOWN, USING A 3/4" SPACER BETWEEN PARTS "E" AND "F"

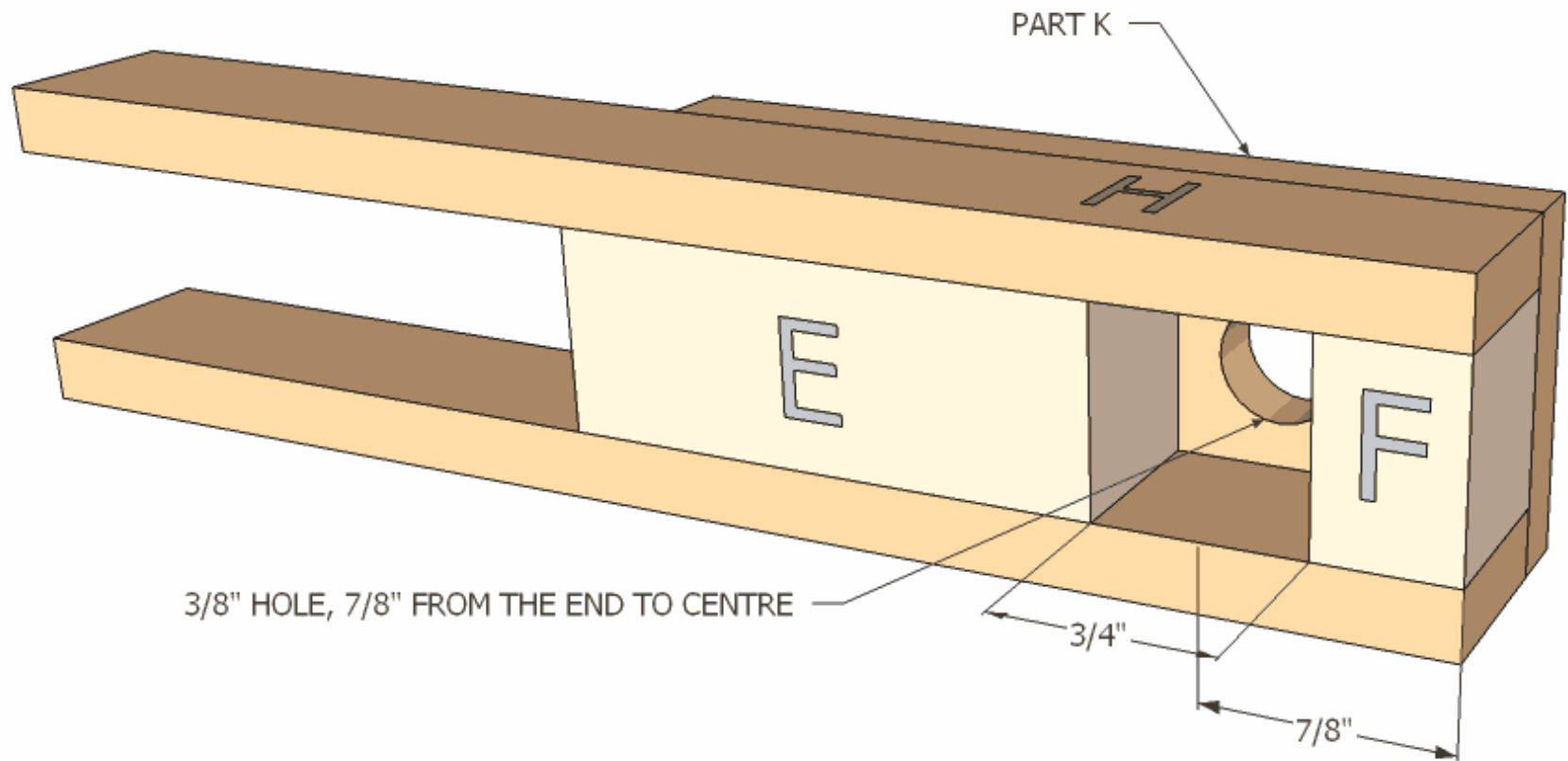

## ASSEMBLY 4

TIGHTEN 2 - 3/8" NUTS ONTO END OF THREADED ROD AND SLIDE THROUGH HOLE IN PART "K" AS ILLUSTRATED.  
ADD THE FLAT WASHER AND REMAINING 3/8" NUTS AND TIGHTEN.  
MAKE SURE THAT THE ROD ASSEMBLY IS FREE TO ROTATE.

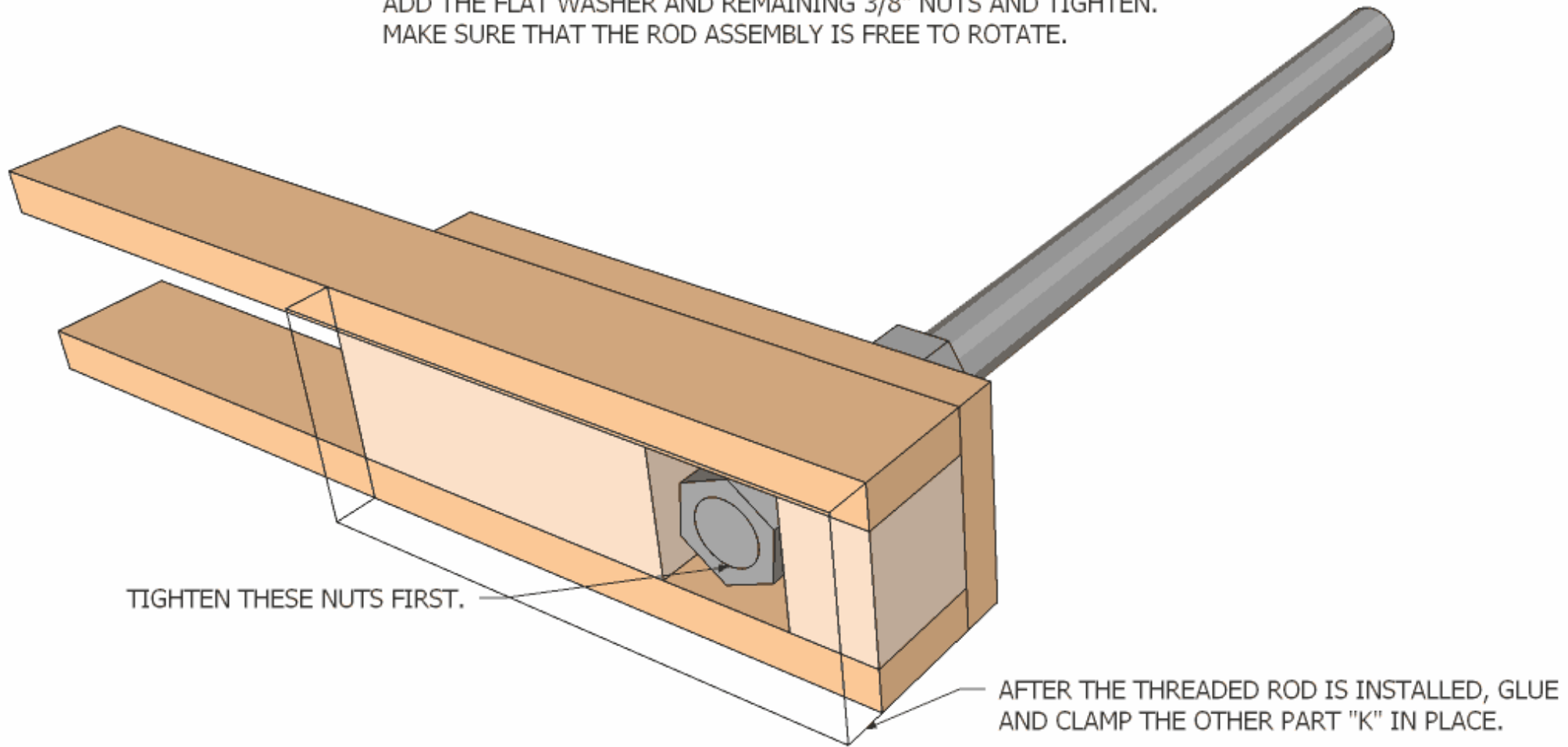

## ASSEMBLY 5

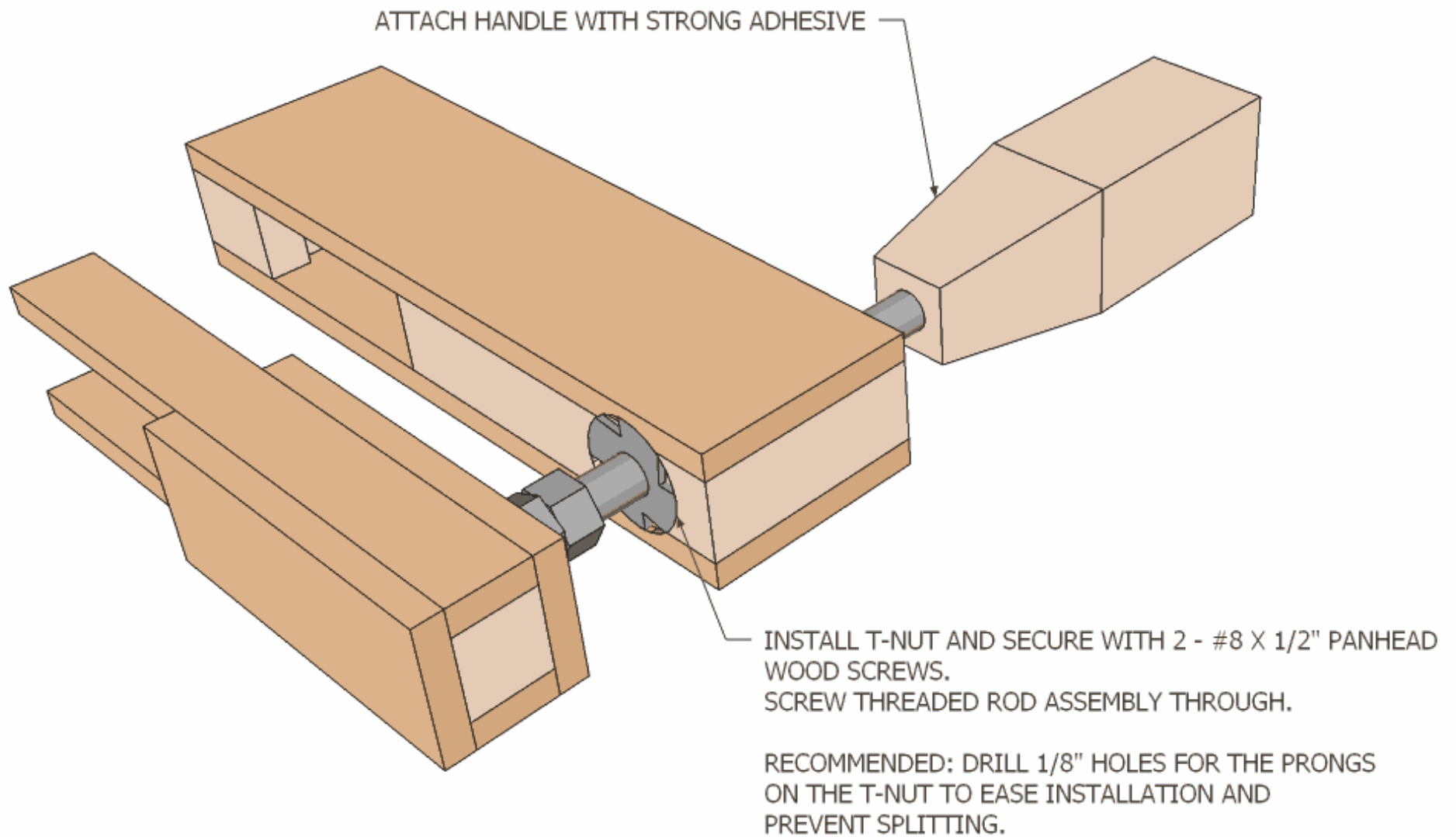

## ASSEMBLY 6

SLIDE MOVING JAW ASSEMBLY ONTO  
BAR "A".  
READY TO USE!

